

Table of Contents

- | [Property Details](#)
- | [Floorplan](#)
- | [Relevant Documents](#)
- | [About Greta](#)
- | [About Us](#)
- | [Disclaimer](#)

Property Details



4 Greta Street, Greta

An Opportunity To Build Your Dream Home Awaits in Tranquil Greta

1  1  5  **Under Offer**

Open Fire Place

Secure Parking

Floor boards

Shed

Discover the potential of this expansive approximate 1891m² block of land with front and rear access, in the serene and rapidly growing suburb of Greta. Whether you envision building your forever home, or revitalizing the existing structures, this property offers endless possibilities.

Build Your Dream Home (Subject to Council Approval):

With ample space for shedding, gardens, and room to roam, this block provides the canvas for your ideal lifestyle. Imagine waking up to the peaceful surroundings, just a short stroll from local village shops, schools, and amenities.

Ideal Location:

Enjoy the tranquillity of a quiet dead-end street while being only a 3-minute drive to the Hunter Expressway. Easily access Newcastle or Sydney, with Branxton and North Rothbury offering additional schooling options and new shopping facilities.

Convenient Lifestyle:

Explore the nearby Huntlee Commercial precinct, Hunter Valley Vineyards, and mining districts. The property also features various carports, storage / work sheds with shelving and

workbenches, and lockable structures for immediate use.

Don't Miss Out: If you're seeking a peaceful retreat, this property offers endless potential. Act now and make your mark in this vibrant community.

This property is proudly marketed by Pat Howard, Aiden Procopis and Jade Tweedie, contact 0408 270 313 or 0456 66 44 81 for further information or to book your private inspection.

NB: Please note, the structures onsite are not currently connected to electricity, however we are told by the vendor electricity is available to the site. Garage roller doors are also only lockable internally, no keys exist for external locking. The moveable caravan and annex structures onsite remain as inclusions.

Disclaimer: All information contained herein is gathered from sources we deem to be reliable. However, we cannot guarantee its accuracy and interested persons should rely on their own enquiries.

First National Real Estate Maitland - We Put You First.



Floorplan

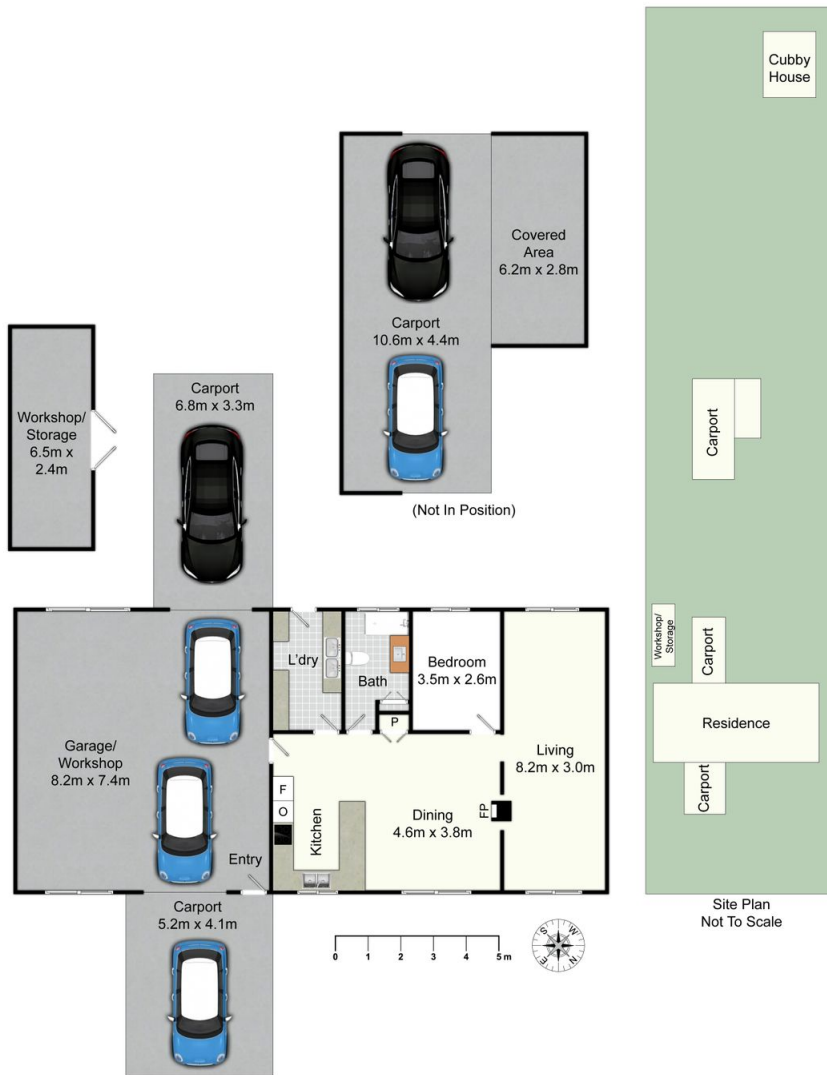

4 Greta St, Greta

All information contained herein is gathered from sources we deem reliable. However, we cannot guarantee its accuracy and act as a messenger only in passing on the details. Interested parties should rely on their own inquiries and the contract for sale. The floor plans are artist's impressions only. The site plan is not to scale.



Relevant Documents

[Marketing Contract](#)

[Make An Offer Form](#)

[Septic Approval Cessnock Council](#)

About Greta

GRETA - HUNTER VALLEY

Located midway between Cessnock, Singleton and Maitland, Greta is largely a commuter town along with its neighbouring sister town Branxton. Both communities often share sporting teams and both provide for great access to the Hunter Expressway. Greta is a mixture of suburban residential lots as well as larger lifestyle and hobby farm properties and a lovely blend of period and new homes. This along with a thriving main street shopping area allows Greta to cater to families. A multi-national award winning Tidy Town, great pride is taken by the townfolks of this community. We acknowledge the Traditional Custodians of Country throughout Australia and pay respects to their elders past, present and emerging. The suburb of Greta falls on the traditional lands of the Mindaribba people.

AROUND GRETA

SCHOOLS:

- Greta Primary School
- Branxton Primary School
- Rosary Park Catholic Primary School Branxton
- St Josephs of Lochinvar High School

CAFES AND RESTAURANTS:

- The Girl & The Goat
- Greta Workers Club
- McDonalds & Subway Greta
- The Royal Federal Hotel Branxton
- Huntlee Tavern North Rothbury
- Various world renowned restaurants 15 minutes drive away in Pokolbin and the Hunter Valley Vineyards

SHOPPING:

- Baileys of Greta
- IGA and Coles (Branxton and North Rothbury)

About Us



JADE TWEEDIE

PRINCIPAL, PARTNER | CLASS 1 LICENCED REAL ESTATE AGENT

0422 48 22 37

jade@fnrem.com.au

A company Partner and one of the four Principal agents at First National Maitland, after 23 years in real estate Jade has gained a wealth of knowledge and skills allowing her to work confidently and successfully in the Maitland / Hunter Valley property market.

Having been around real estate both professionally and outside of the professional domain, Jade understands the various processes as well as the emotional facets involved in what is usually your most valued asset.

Being highly organised whilst always working hard to provide exceptional customer service, is what Jade prides herself on. Her friendly nature, positive attitude and understanding of the overall real estate process from both an investment and sales view, allows her to work well within our successful team of professionals and most importantly with our valued clients.

In the past, Jade has worked within First National Maitland as a full time Sales Agent and received First Nationals NSW Silver Achiever Award for outstanding performance in real estate sales two years running, in 2014 and 2015. Previous to this however, Jade worked her way up the ladder in the Property Investment sector, starting as a Property Officer and working through to the top as Senior Portfolio Manager, in which she was responsible for the management of a multi million dollar rental roll.

Jade is and has also been responsible for building our Boutique Management Portfolio which exists First National Maitland today, to which she has taken out the highest of accolades on both State and National levels consistently in the last 8 years, for the entire FN Network abroad.

A long term staff member at FN Maitland since 2006, Jade continues to oversee the company's growth and development along side Alexandra and Michael Haggarty and our Property Sales and Investment Teams!

Disclaimer

First National Real Estate Maitland a declare that all information contained herein is gathered from sources we deem to be reliable. However, we cannot guarantee its accuracy and interested persons should rely on their own inquiries.

All images in this e-book are the property of First National Real Estate Maitland. Photographs of the home are taken at the specified sales address and are presented with minimal retouching. No elements within the images have been added or removed.

Plans provided are a guide only and those interested should undertake their own inquiry.